



Union Special®
LEWIS • COLUMBIA

INDUSTRIAL
SEWING
MACHINES

FINEST QUALITY

CLASSES

17
and
24

LIST OF PARTS

FOR

17-100
17-130

24-120
24-130

CATALOG
NO.

T194-8

Union Special MACHINE COMPANY
CHICAGO

From the library of: Superior Sewing Machine & Supply LLC

Catalog No. T194-8

LIST OF PARTS

Styles

17-100	24-120
17-130	24-130

First Edition

Copyright 1961
by
Union Special Machine Co.
Rights Reserved in All Countries

Union Special
MACHINE COMPANY
INDUSTRIAL SEWING MACHINES
CHICAGO

Printed in U.S.A.

June, 1973

IDENTIFICATION OF MACHINES

Each Union Special Lewis machine carries a style number which is stamped in the style plate on the column of the machine.

The serial number of each machine is stamped in the left main shaft bushing boss in the head of the machine.

APPLICATION OF CATALOG

This catalog applies specifically to Styles 17-100, 17-130, 24-120 and 24-130. All references to direction, such as right and left, front and back, etc., are taken from the operator's position while seated at the machine.

The operating direction of the handwheel is away from the operator.

DESCRIPTION OF MACHINES

17-100 A 45°, one needle, two thread raised flat bed lockstitch blindstitch machine, for felling facings and bottoms of quarter lined and half lined sack coats and overcoats finished with piped edges or turned under edges. Makes a straight line stitch and can be adjusted to produce a 2 to 1 skip stitch or a non-skip stitch.

17-130 Fitted with automatic tension release for sewing thin, light weight materials, otherwise, same as Style 17-100.

24-120 A 90°, one needle, two thread raised flat bed lockstitch blindstitch machine, for felling together the canvas and cloth at the edge of sack coats and top coats finished with a plain or bluff edge. Stitches up to 1/4 inch from bluff edge.

24-130 Same as Style 24-120 except for overcoats. Stitches up to 1/2 inch from bluff edge.

OILING

The machine should be oiled twice daily, before the morning and afternoon starts. Use a good grade of straight mineral oil of a Saybolt viscosity of 90 to 125 seconds at 100° Fahrenheit.

Most of the oiling places on the machine are readily identified because of the fact they are painted red.

Remove work support plate, head cover and arm cover for easier access to oiling places.

Clean lint and dirt from the moving parts daily to insure trouble free operation. See that the feed points are kept clean. Accumulation of lint in the feed points will cause the machine to feed improperly.

SPEED

The recommended speed for Styles 17-100 and 17-130 is 1200 R.P.M.

The recommended speed for Styles 24-120 and 24-130 is 1100 R.P.M.

NEEDLES

Use only genuine Union Special Lewis needles. They are stamped with the word "Lewis" on the shank.

Needles for these machines are available with either a uniform blade or ball eye.

The recommended needle for Styles 17-100 and 17-130 is Type 29-133-1/2. It is a ball eye needle with a .035 inch diameter blade. It is also available in the following sizes:

NEEDLE TYPE	SIZE
29-132-1/2	.025
29-133	.030
29-134	.040
29-134-1/2	.045

The recommended needle for Styles 24-120 and 24-130 is Type 29-123-1/2. It is a uniform blade needle with a .035 inch diameter blade. It is also available in the following sizes:

NEEDLE TYPE	SIZE
29-123	.030
29-124	.040
29-124-1/2	.045

Selection of proper needle size is determined by size of thread and weight, and type of material used. Thread should pass freely through needle eye in order to produce a good stitch formation.

To have needle orders promptly and accurately filled, an empty container, a sample needle, or the type number should be forwarded. Use the description on the label. A complete order would read: "100 Needles, Type 29-133-1/2".

IDENTIFYING PARTS

Where construction permits, each part is stamped with its part number. Part numbers represent the same parts, regardless of catalog in which they appear.

USE GENUINE NEEDLES AND REPAIR PARTS

Success in the operation of these machines can be secured only with genuine Union Special Lewis Needles and Repair Parts as furnished by the Union Special Machine Company, its subsidiaries and authorized distributors. They are designed according to the most approved scientific principles, and are made with utmost precision. Maximum efficiency and durability are assured.

Genuine needles are packaged with labels marked Lewis *Union Special*. This trade mark is your guarantee of the highest quality in materials and workmanship.

TERMS

Prices are strictly net cash and are subject to change without notice. All shipments are forwarded f.o.b. shipping point. Parcel Post shipments are insured unless otherwise directed. A charge is made to cover postage and insurance.

The following is a numerical list of parts used in Styles 17-100, 17-130, 24-120, 24-130. Quantities, part numbers and descriptions are given. Unless otherwise specified, the parts listed are used on all four machines. Following the parts list are photographs of some of the major parts.

Amt.	Part No.	Description	Amt.	Part No.	Description	Amt.	Part No.	Description
1	4-129	Work Support Plate for Styles 24-120, 24-130 (LS395)	4	21-27	Spring for 75-60, 75-61 on Style 24-130 (18-125)	1	46-94	Feed Elevating Link (1249 L)
1	5-168	Presser Foot, main section for 405-168	1	21-229	Plunger Spr. for Style 24-120	1	47-50	Feed Rocker Connecting Rod for Style 24-130, (1206 L, 1244 L)
1	LS7 A	Feed Adjuster Crank Disc (1210 L, 1211 L)	1	21-284	Thread Tension Spring for Style 17-100	1	47-114	Feed Elevating Connecting Rod for Style 24-130 (1288 L)
1	LS9	Plunger Differential Link (1244 L, 1288 L)	1	21-410	Front Cover Latch Spring	1	47-115	Feed Elevating Connecting Rod for Styles 17-100, 17-130, 24-120 (1288 L)
1	14-2	Hook Shaft for 1034 AL	1	LS21 A	Feed Elevating Crank, complete (LS301)	1	LS51	Feed Depresser Lever
1	14-161	Plunger Adjuster Shaft for Style 24-130	1	22-21	Feed Plate Guide Separating Pin for Styles 24-120, 24-130 (1022 L)	1	57-42	Handwheel, 4 11/16 P. D. (CS320 1/2)
1	14-324	Main Shaft (18-748)	1	22-195	Thread Tension Disc Pin for Styles 17-130, 24-120, 24-130	1	57-45	Handwheel, 3 1/4 P. D. (CS320-1/2)
1	16-266	Bobbin Case Release Lever Bushing for 445-251	1	22-298	Head Cover Hinge Pin	1	61-46	Oil Tube
1	16-353	Main Shaft Needle Bearing Bushing	1	LS22	Work Support Plate for Styles 17-100, 17-130 (LS395)	1	61-47	Oil Tube
1	16-367	Main Shaft Bushing, left	1	23-107	Feed Point for Style 24-130	1	LS65	Plunger Elevating Shaft Crank for LS165 A
1	16-368	Main Shaft Bushing, right	1	23-324	Feed Point for Styles 17-100, 17-130	1	68-3	Feed Plate Staff for 424-8
1	16-394	Feed Elevating Shaft Bushing	1	LS23 N	Feed and Plunger Bearing Block for Styles 17-100, 17-130 (LS317)	1	68-3	Feed Plate Staff for Style 24-130
2	18-106	Screw for 75-15, 75-16 on 424-8	1	24-8	Adjustable Feed Plate for 424-8	1	68-19	Thread Controller Staff (LS330)
2	18-106	Screw for 75-60, 75-61 on Style 24-130	1	24-288	Feed Plate for Styles 17-100, 17-130 (1414 L)	1	LS70-1/2	Vertical Shaft Bearing Block (1158 L)
2	18-125	Screw for 21-27 on 424-8	1	26-33	Long Plunger for Style 24-130	1	LS71	Skip Stitch Adjusting Crank (18-736)
2	18-125	Screw for 21-27 on Style 24-130	1	26-34	Short Plunger for Style 24-130	1	LS74	Skip Stitch Crank Pin
1	18-227	Screw for 416-11	1	LS30	Feed Elevating Shaft Crank for LS130 A	1	75-15	Feed Plate Guide, left, for 424-8 (18-106)
1	18-281	Screw for 1346 L on 1343 SAL	1	32-281	Head Cover for Styles 17-100, 17-130 (18-1047)	1	75-16	Feed Plate Guide, right, for 424-8 (18-106)
4	18-475	Screw for holding arm to base on Style 24-130	1	32-285	Head Cover for Styles 24-120, 24-130 (18-1047)	1	75-60	Feed Plate Guide, left, for Style 24-130 (18-106)
1	18-533	Set Screw for 1273 L	1	32-287	Cover for top of arm (18-596)	1	75-61	Feed Plate Guide, right, for Style 24-130 (18-106)
2	18-596	Screw for 32-287	1	34-93	Plunger Elevating Cam for Styles 24-120, 24-130	1	75-249	Edge Guide for 405-168, 1571 AL (1351 L)
1	18-719	Screw for 445-251	1	39-128	Collar for main shaft (18-957)	1	LS75	Skip Stitch Crank Spring
1	18-736	Screw for LS71	1	40-187	Washer	1	LS76	Skip Stitch Adjusting Crank Nut
1	18-745	Bearing Screw for 1672 L	1	41-28	Needle Clamp Thread Guide Plate, lower, for 1432 AL (1036 L)	1	89-58	Hole Plug in end of arm
1	18-748	Screw in end of 14-324	1	41-55	Thread Guide Pin, from spool	1	98-6	Transfer
1	18-912	Screw for 1043 L on 1041 AL	1	LS42	Hinge Bracket for LS42 A	1	115-162	Feed and Plunger Bearing Block for Styles 24-120, 24-130 (LS317)
2	18-957	Screw for 39-128	1	LS42 A	Bench Bracket, complete	1	115-163	Plunger Elevating Slide Block for Styles 24-120, 24-130
2	18-1045	Screw for holding head to arm	1	LS43	Plunger Cradle for LS43 A	1	LS120	Vertical Shaft for plunger adjuster on Styles 17-100, 17-130, 24-120
4	18-1045	Screw for joining arm and base for Styles 17-100, 17-130, 24-120	1	LS43 A	Plunger Cradle, complete (LS398)	1	LS122	Feed Elevating Shaft for LS130 A
1	18-1047	Knurled Adjusting Screw for 32-281	1	45-251	Bobbin Case Release Lever for 445-251	1	LS122	Feed Rocker Shaft for LS135 A
1	18-1047	Knurled Adjusting Screw for 32-285	1	46-15	Feed Link for Styles 24-120, 24-130 (1260 L)			
1	LS19 A	Feed Rocker Crank, complete (LS301)						
1	20-60	Thread Tension Adjusting Nut for Style 17-100						
1	LS20 A	Plunger Elevating Crank, complete, for Styles 17-100, 17-130 (LS301)						
1	LS20 CMA	Plunger Elevating Crank, complete, for Styles 24-120, 24-130 (LS301)						
1	21-26	Feed Pressure Spr., short, for Styles 24-120, 24-130						
4	21-27	Spring for 75-15, 75-16 on 424-8 (18-125)						

Amt.	Part No.	Description	Amt.	Part No.	Description	Amt.	Part No.	Description
1	LS122	Feed Rocker Crank Shaft for 448-6	1	LS395	Clamp Screw for LS22	2	1005 L	Set Screw for 1001 L
1	LS123	Plunger Elevating Shaft for LS165 A	1	LS396	Plunger Elevating Cam Stud on Styles 24-120, 24-130 (CS232)	1	1005 L	Set Screw for 1146 L
4	125-23	Oil Cup				1	1005 L	Set Screw for 1146 SL
1	LS130 A	Feed Elevating Shaft, complete, with crank (1249 L)	2	LS397	Pivot Screw for LS294 (LS299)	1	1005 L	Set Screw for 1200 L
1	LS135 A	Feed Rocker Shaft, complete, with crank, for Styles 17-100, 17-130	1	LS398	Pivot Screw for LS43 A (LS299)	1	1005 L	Set Screw for 1201 L
1	LS165 A	Plunger Elevating Shaft, complete, with crank	1	401-6	Head for Style 17-130	1	1006 L	Needle Carrier Connecting Link for Styles 17-100, 17-130
			1	401-14-1/2	Head for Styles 24-120, 24-130 (18-1045)	1	1006 SL	Needle Carrier Connecting Link for Styles 24-120, 24-130
			1	LS403	Plunger Adjuster Spring for Styles 24-120, 24-130	1	1007 L	Needle Carrier
1	LS201	Feed Rocker Shaft Bushing	1	LS403 S	Plunger Adjuster Spring for Styles 17-100, 17-130	1	1008 L	Needle Carrier Driving Stud (1009 L)
1	LS207	Roll for plunger elevating cam slot on Styles 24-120, 24-130 (1251 L)	1	405-168	Presser Foot, complete, for Style 24-130 (1073 L)	1	1009 L	Nut for 1008 L
1	LS210	Feed Elevating Eccentric (1005 L, 1147 L)	1	LS405	Long Feed Spring (LS394)	1	1009 L	Nut for 1010 L
1	LS214	Lock Nut for LS324	1	416-11	Adjustable Hook Bushing, complete marked "B", (18-227)	2	1009 L	Nut for 1244 L
2	LS215	Center Bearing for LS43 A	1	424-8	Feed Plate, complete, for Style 24-120	2	1009 L	Nut for 1288 L
1	LS219 A	Plunger Adjuster Knob, complete (LS220, CS335)	1	424-77	Adjustable Feed Plate for Style 24-130	1	1010 L	Needle Carrier Bearing Stud, left (1008 L)
1	LS220	Nut for LS219 A	1	445-234	Take-up Lever, complete, for Styles 24-120, 24-130	1	1011 L	Needle Carrier Bearing Stud, right (1012 L)
1	LS225	Feed Spring Slide Block Guide Pin	1	445-251	Bobbin Case Release, complete (18-719)	1	1012 L	Nut for 1011 L
1	CS231	Nut for 18-1047	1	448-6	Feed Rocker Crank, complete with shaft for Styles 24-120, 24-130	1	1014 L	Clamp Screw for 1432 AL
1	CS231	Nut for 1558 SL on Styles 17-130, 24-120, 24-130	1	470-6	Plunger Sleeve, complete, for Styles 24-120, 24-130 (1251 L)	1	1016 L	Needle Clamp Thread Guide Plate, upper, for 1432 AL (1036 L)
2	CS232	Nut for LS324, LS396 on Styles 24-120, 24-130	1	478-10	Pulley Needle Bearing	1	1018 AL	Take-up Lever, complete, for Styles 17-100, 17-130
1	LS294	Cam for producing 2 to 1 skip stitch (LS397)	1	478-13	Main Shaft Needle Bearing	1	1019 L	Take-up Lever Bearing Shaft (1020 L)
1	LS295	Skip Stitch Cam Roll (LS393)	1	CS510	End Thrust Washer for 1139 L (CS337)	2	1020 L	Set Screw for 1019 L, 1212 L
3	LS299	Lock Nut for LS397, LS398	1	FP539	Clamp Screw for 1415 L on 1417 AL	1	1021 L	Collar for 1019 L (1022 L)
1	LS301	Clamp Screw for LS19 A, LS20 A, LS20 CMA, LS21 A	1	LS541	Plunger Adjuster Retaining Spring (LS314)	1	1022 L	Set Screw for 1021 L
1	LS302	Bearing Screw for 1304 L on Styles 17-100, 17-130 (1160 L)	2	666-65	Oil Wick	1	1022 L	Set Screw for 22-21 on Styles 24-120, 24-130
1	LS314	Screw for LS541	1	LS670	Spiral Gear for LS120 and 14-161 (1025 L, 1031 L)	1	1023 L	Take-up Lever Slide Block
1	LS314	Screw for 1555 L on Styles 17-130, 24-120, 24-130	1	LS671	Vertical Plunger Shaft Driving Gear (1025 L, 1031 L)	1	1024 L	Spiral Gear for Timing Hook (1025 L, 1029 L, 1031 L)
1	LS316	Plunger Adjuster Knob Shaft for LS219 A	1	LS672 A	Cam Roll Block, complete (CS328)	1	1025 L	Set Screw for LS670
1	CS317	Spot Screw for 57-45	2	LS674	Plunger Frame for Styles 17-100, 17-130	1	1025 L	Set Screw for LS671
1	CS317-1/2	Set Screw for 57-45	1	LS675	Bearing Center for LS43 A (1005 L)	1	1025 L	Set Screw for 1024 L for Style 24-120
2	LS317	Clamp Screw for LS23 N	1	892 L	Screw for 1573 L on 405-168, 1571 AL	2	1026 L	Set Screw for 1028 L
2	LS317	Clamp Screw for 115-162	1	1001 L	Needle Crank (1002 L, 1003 L)	1	1027 L	Hook Timing Shaft on Style 17-100
2	CS320 1/2	Set Screw for hand-wheel	1	1002 L	Spot Screw for 1001 L	2	1028 L	Hook Timing Shaft Collar (1029 L)
1	LS324	Feed Depresser Lever Stud (LS214, CS232)	1	1002L-1/2	Spot Screw for 1146 L	1	1029 L	Hook Timing Shaft Bevel Gear (1025L)
1	CS328	Clamp Screw for LS672	1	1002L-1/2	Spot Screw for 1146 SL	1	1029 L	Set Screw for 1024 L
1	LS330	Set Screw for 68-19	1	1003 L	Set Screw for 1001 L	2	1029 L	Set Screw for 1027 L
1	CS335	Screw for LS219 A	1	1004 L	Needle Driving Stud	1	1030 L	Set Screw for 1030 L
1	CS337	Screw for CS510	1	1005 L	Set Screw for LS210	1	1030 L	Hook Shaft Bevel Gear (1029 L, 1031 L)
1	LS393	Screw for LS295	1	1005 L	Set Screw for LS675	3	1031 L	Spot Screw for LS670, LS671, 1030 L
1	LS394	Screw for LS405	1			1	1031 L	Spot Screw for 1024 L on Styles 17-100, 17-130, 24-130
1	LS395	Clamp Screw for 4-129	1			1	1033 L	Hook for 1034 AL

Amt.	Part No.	Description	Amt.	Part No.	Description	Amt.	Part No.	Description
3	1036 L	Screw for 1035 L on 1040 A-1 L	1	1146 SL	Head Main Shaft	1	1256 L	Feed Retaining Spring for feed point on Styles 17-100, 17-130, 24-130
1	1036 L	Screw for clamping 41-28 and 1016 L on 1432 AL			Hook Drive Gear for Styles 24-120, 24-130(1002L-1/2, 1005 L)			
1	1037 L	Hook Gib for 1040 A-1 L (1039 L)	1	1147 L	SpotScrew for LS210	1	1256 L	Feed Retaining Spring for 1589 AL-1/2
2	1039 L	Screw for 1037 L on 1040 A-1 L	2	1158 L	Screw for LS70-1/2			
1	1040 A-1 L	Hook, complete with bobbin case	1	1160 L	Nut for LS302	1	1257 L	Feed Rocker Shaft Crank for LS135 A
1	1041 AL	Bobbin Case complete for 1040 A-1 L	1	1160 L	Nut for 1249 L	1	1257L-1/2	Feed Rocker Crank for 448-6
1	1043 L	Tension Spring for 1041 AL (1046 L)	1	1160 L	Nut for 1251 L	1	1260 L	Screw for 46-15 (1160 L)
1	1046 L	Tension Screw for 1043 L on 1041 AL	1	1160 L	Nut for 1260 L	1	1260 L	Screw for 1261 L (1160 L)
1	1047 L	Bobbin	1	1160 L	Nut for 1303 L	1	1261 L	Feed Link for Styles 17-100, 17-130 (1260 L)
1	1049 L	Bobbin Case Release Spring Pin for 445-251	1	1181 L	Pigtail Thread Eyelet	1	1262 L	Feed Link Hinge Pin
1	1053 L	Stop Pin for 445-251	1	1182 AL	Tension Staff, complete, for Style 17-100 (1081 L)	1	1272 L	Feed Spring Nut
1	1054 L	Spring for 445-251	2	1183 L	Tension Disc	1	1273 L	Feed Spring Slide Block (18-533)
1	1055 L	Spring Pin for 1054 L	1	1185 L	Washer for 68-19	2	1284 L	Collar for LS130 A, 448-6, LS135 A
1	1056 L	Bobbin Case Release Lever	1	1186 L	Thread Controller Staff Barrel	1	1288 L	Screw for LS9
1	1057 L	Bobbin Case Retainer for 1343 SAL (1058 L)	1	1187 L	Thread Controller Spring	1	1288 L	Screw for 17-114
1	1057 L	Bobbin Case Retainer for 405-168, 1571 AL (1058 L, 1577 L)	1	1188 L	Thread Controller Staffstop (1189 L)	1	1288 L	Screw for 47-115
1	1058 L	Screw for 1057 L on 405-168, 1571 AL	1	1189 L	Screw for 1188 L	1	1303 L	Bearing Stud for 1304 L on Styles 17-100 and 17-130 (1160 L)
2	1058 L	Screw for 1057 L on 1343 SAL	1	1200 L	Gear on Main Shaft for driving head on Styles 17-100, 17-130 (1005 L, 1203 L)	1	1304 L	Plunger Frame Link for Styles 17-100, 17-130 (LS302, 1303 L)
1	1059 L	Needle Bar Bushing, left	1	1201 L	Gear on Main Shaft for driving head on Styles 24-120, 24-130 (1005 L, 1203 L)	1	1309 L	Plunger Barrel Spring, heavy, for Styles 17-100, 17-130
1	1060 L	Needle Bar Bushing, right	1	1203 L	Spot Screw for 1200 L	2	1311 L	Nut for 1357 L
1	1072 L	Hook Gear Cover for 1072 AL	1	1203 L	Spot Screw for 1201 L	2	1311 L	Nut for 1578 L
1	1072 AL	Hook Gear Cover, complete (1073 L)	1	1205 L	Feed Rocker Connecting Rod for Styles 17-100, 17-130, 24-120 (1206 L, 1244 L)	1	1321 L	Bushing, left, for LS43 A
2	1073 L	Screw for 1072 AL	1	1206 L	Screw for 47-50	1	1321L-1/2	Bushing, right, for LS43 A
2	1073 L	Screw for attaching presser feet	1	1206 L	Screw for 47-114	2	1326 L	Hinge for LS42 A (1327 L)
1	1074 L	Thread Clip and cutter for 1072 AL (1075 L)	1	1206 L	Screw for 47-115	4	1327 L	Screw for 1326 L on LS42 A
1	1075 L	Screw for 1598 L-1/4 on 405-168, 1571 AL	1	1210 L	Screw for 1205 L	4	1327 L	Screw for 1328 L
1	1075 L	Screw for 1074 L on 1072 AL	1	1211 L	Spot Screw for LS7 A	2	1328 L	Hinge on base (1327 L)
1	1075 L	Screw for 1348 BL-1/4 on 1343 SAL	1	1212 L	Set Screw for LS7 A	1	1335 AL	Head for Style 17-100
1	1081 L	Set Screw for 1182 AL on Style 17-100	1	1213 L	Feed Adjuster Eccentric (1020 L, 1213 L)	1	1343 SL	Presser Foot, main section for 1343 SAL
1	1132 L	Tension Staff Spring, front, for Styles 17-130, 24-120, 24-130	2	1214 L	Feed Adjuster Eccentric Spring	1	1343 SAL	Presser Foot, complete, for Styles 17-100, 17-130 (1073 L)
2	1134 L	Tension Staff Adjusting Nuts for Styles 17-130, 24-120, 24-130	1	1244 L	Screw for LS9, 1205 L	1	1346 L	Needle Guard for 1343 SAL (18-281)
1	1139 L	Head Main Shaft	1	1244 L	Screw for 47-50	1	1348BL-1/4	Needle Guide for 1343SAL (1075 L)
1	1143 L	Head Main Shaft Drive Gear for Styles 17-100, 17-130	1	1246 L	Feed Rocker Shaft Crank Pin for LS135 A	1	1351 L	Screw for 1373 BL on 1343 SAL
1	1144 L	Head Main Shaft Drive Gear for Styles 24-120, 24-130	1	1246 L	Plunger Adjuster Knob Pin for LS219 A	3	1351 L	Screw for 75-249, 1575 L, on 405-168, 1571 AL
1	1146 L	Head Main Shaft Hook Drive Gear for Styles 17-100, 17-130 (1002L-1/2, 1005 L)	1	1246L-1/2	Feed Rocker Crank Pin for 448-6	1	1357 L	Plunger for Styles 17-100, 17-130 (1311 L)
			1	1246L-1/2	Feed Elevating Shaft Crank Pin for LS130 A	1	1368 OSL	Plunger Equalizing Spring for Styles 17-100, 17-130
			1	1249 L	Plunger Elevating Shaft Crank Pin for LS165 A	1	1373 BL	Edge Guide for 1343SAL (1351 L)
			1	1249 L	Stud for LS130 A (1160 L)	1	1413 L	Feed Plate Stem for 1417 AL
			2	1251 L	Screw for 46-94 (1160 L)	2	1414 L	Screw for 24-288
			1	1254 L	Screw for LS207, 470-6	1	1415 L	Feed Plate Yoke for 1417 AL (FP539)
					Spring Pin for 1677 AL			

Amt.	Part No.	Description	Amt.	Part No.	Description	Amt.	Part No.	Description
1	1417 AL	Feed Plate Yoke, complete, for Styles 17-100, 17-130	1	1558 SL	Pilot Screw for 1553 L (CS231)	1	1598L-1/4	Needle Guide for 405-168, 1571AL (1075 L)
1	1420 L	Needle Clamp Pin for 1432 AL	1	1571 L	Presser Foot, main section for 1571 AL	1	1669 L	Feed Elevating Bell Crank (1251L)
1	1432 AL	Needle Clamp, complete (1014 L)	1	1571 AL	Presser Foot, complete, for Style 24-120 (1073 L)	1	1670 L	Feed Elevating Link for 1677 AL
1	1493 L	Adjusting Screw for 1573 L on 405-168, 1571 AL	1	1573 L	Crown for 405-168, 1571 AL (892 L, 1493 L)	2	1671 L	Bearing Screw for 1677 AL
1	1551 L	Hook Timing Shaft for Styles 17-130, 24-120, 24-130	1	1575 L	Needle Guard for 405-168, 1571AL (1351 L)	1	1672 L	Feed Spring Slide Block Roll, .500 inch dia. (18-745)
1	1552 L	Gear and Cam Shaft for automatic tension release on Styles 17-130, 24-120, 24-130	1	1577 L	Screw for 1057 L on 405-168, 1571 AL	1	1672 L-1	.505 inch dia, marked "1"
1	1553 L	Tension Shaft for Styles 17-130, 24-120, 24-130 (1558 SL)	1	1578 L	Plunger, long, for Style 24-120(1311L)	1	1672 L-2	.510 inch dia, marked "11"
1	1554 L	Tension Staff Spring, rear, for Styles 17-130, 24-120, 24-130	1	1579 L	Plunger, short, for Style 14-120	1	1672 L-3	.515 inch dia, marked "111"
1	1555 L	Gear and Cam Shaft Latch for Styles 17-130, 24-120, 24-130 (LS314)	1	1584 L	Plunger Spring for Style 24-130	1	1677 AL	Feed Elevating Link, complete, (1671 L)
1	1556 L	Adjusting Nut for 1553 L (1557 L)	1	1586 L	Rear Work Support for Styles 24-120, 24-130	1	1778 L	Retaining Spring for 1493 L on 405-168, 1571 AL (1036 L)
1	1557 L	Lock nut for 1556 L	1	1589L-1/2	Feed Point, for 1589AL-1/2	1	4129-15	Knee Lift Assembly
			1	1589AL-1/2	Feed, complete, for Style 14-120 (1260 L)	1	4129-18	Knee Press Pad, complete, for 4129-15
						1	54274 P	Washer
						1	61477	Bobbin Winder, complete

NOTE: Numbers in parentheses following parts' description indicate the screws, nuts, etc. used to attach or hold these parts.

The catalog listing shows the presser foot and plunger combinations with which the standard machines are equipped. The following substitutions can be made to compensate for variations in weights of materials used.

<u>MACHINE STYLE</u>	<u>PRESSER FOOT</u>	<u>PLUNGER</u>	<u>MATERIAL</u>
17-100, 17-130	1343 AL	1357 L	Turned Under Edges
17-100, 17-130	*1343 SAL	1357 L	Light and Medium
17-100, 17-130	1373 AL	1357 L	Medium
17-100, 17-130	1373 SAL	1357 L	Extra Heavy
24-120	*1571 AL	1578 L	Light
		1579 L	
24-120	1593 AL	1591 L	Medium to Heavy
		1592 L	
24-120	1593 SAL	1591-1/2 L	Extra Heavy
		1592-1/2 L	
24-130	405-167	26-31	Light
		26-32	
24-130	* 405-168	26-33	Medium
		26-34	
24-130	405-169	26-35	Heavy
		26-36	

*Standard equipment on machine.

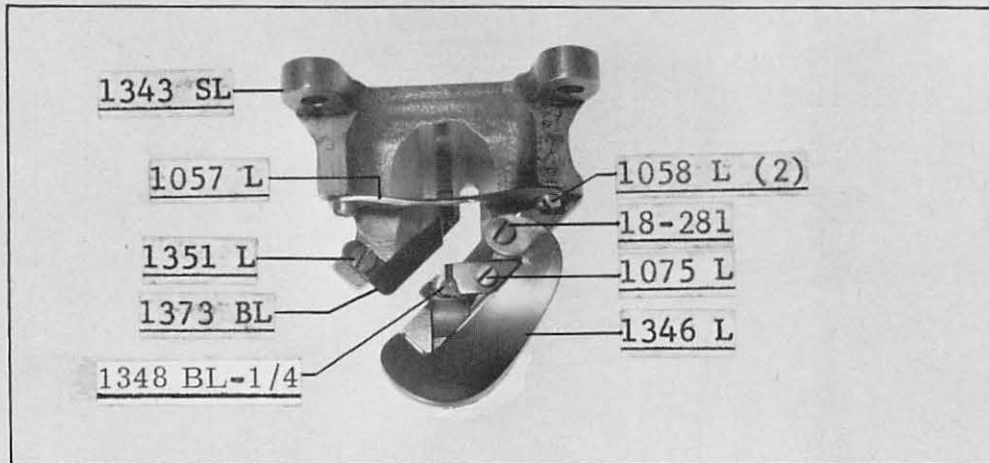

1343 SAL
Complete Assembly

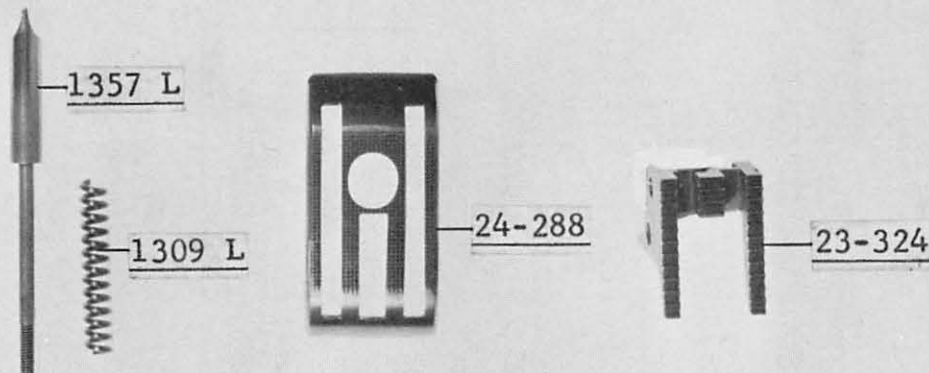

1571 AL
Complete Assembly

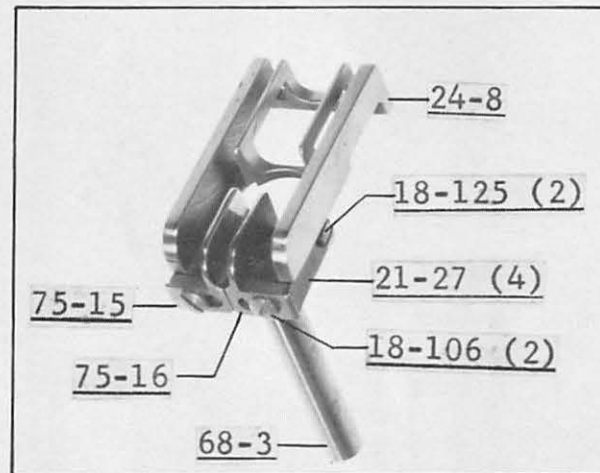
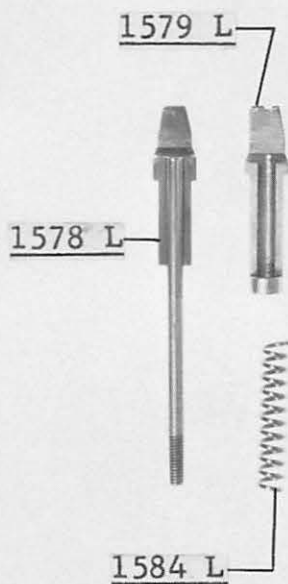
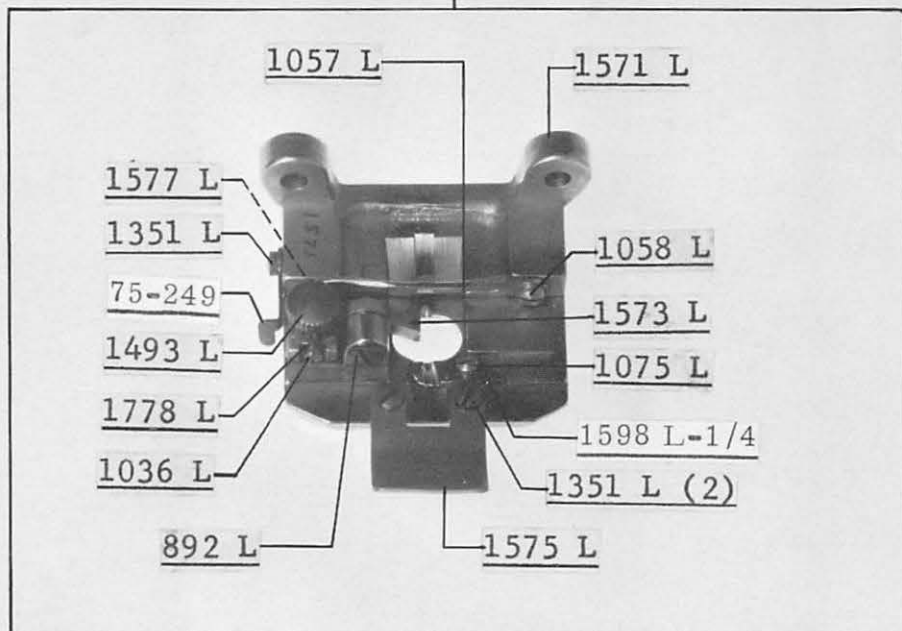

424-8
Complete Assembly



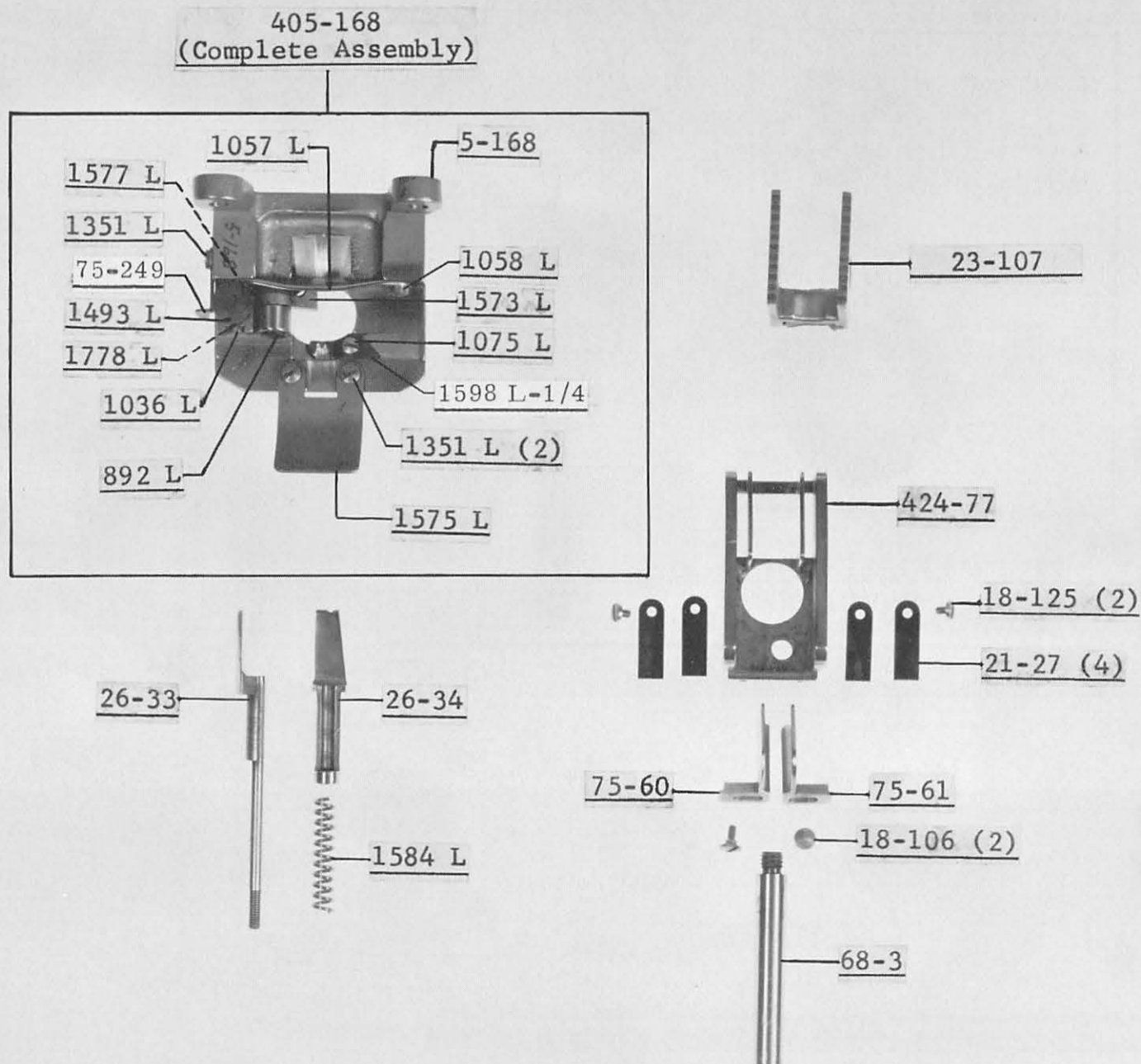

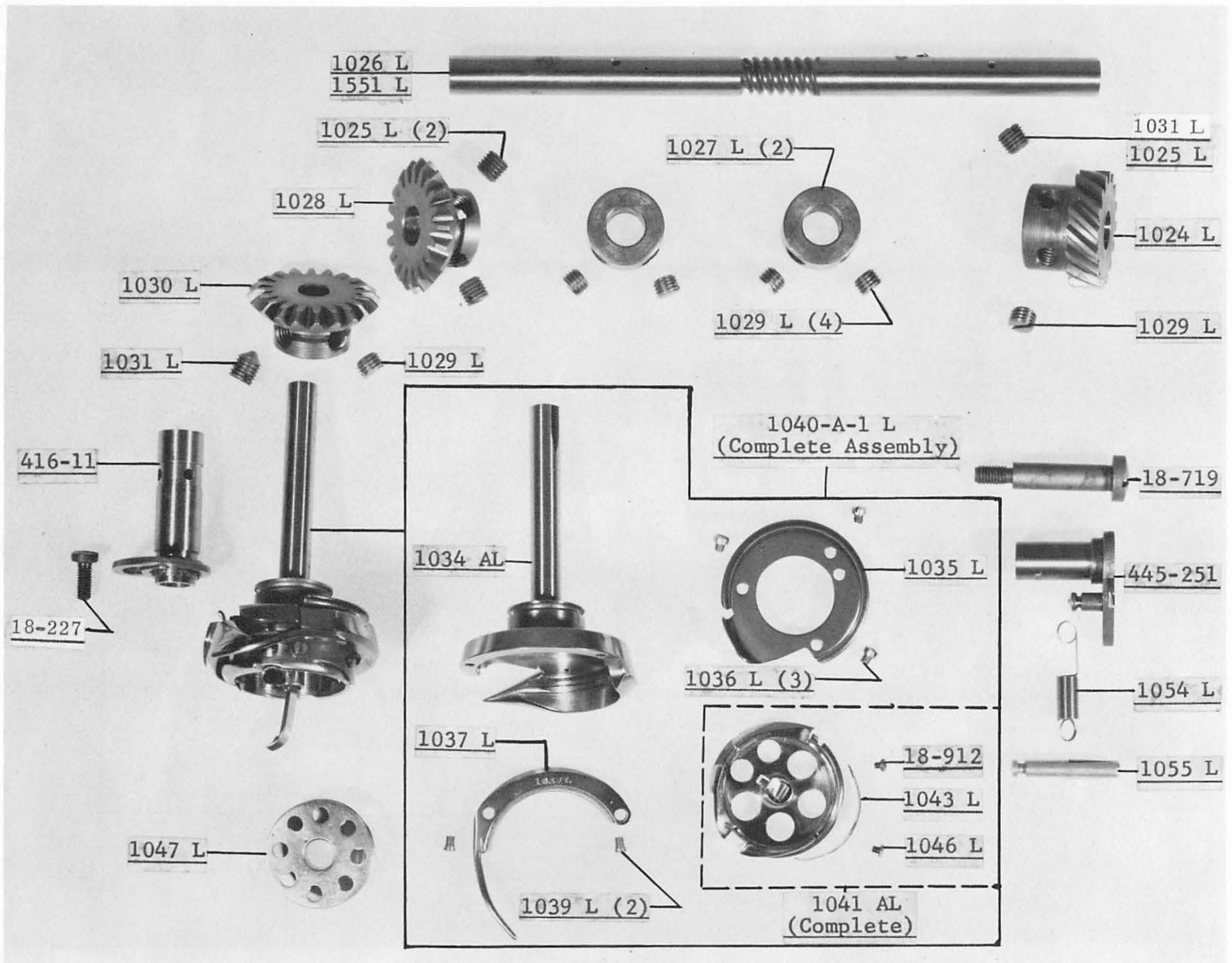

From the library of: Superior Sewing Machine & Supply LLC

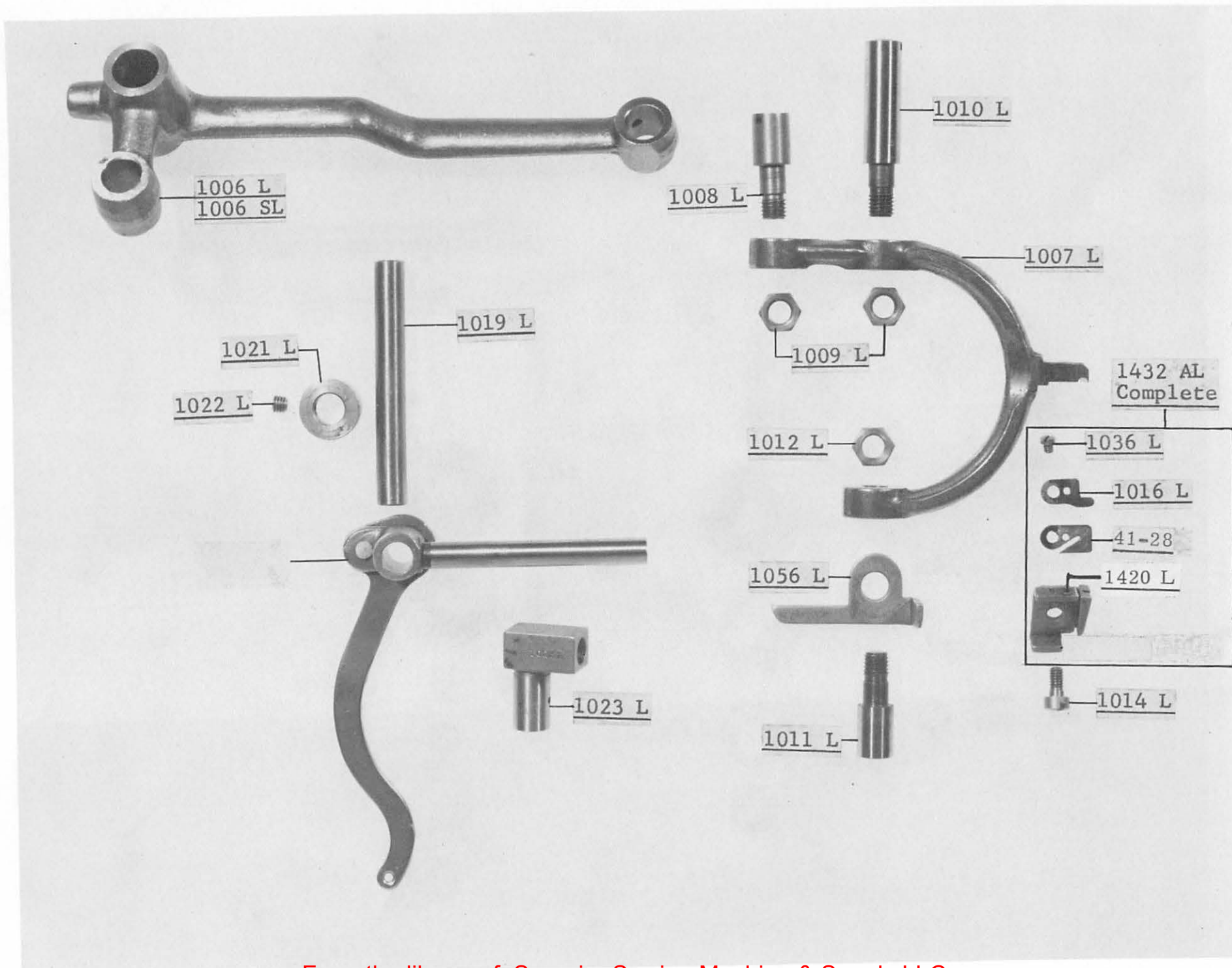

From the library of: Superior Sewing Machine & Supply LLC

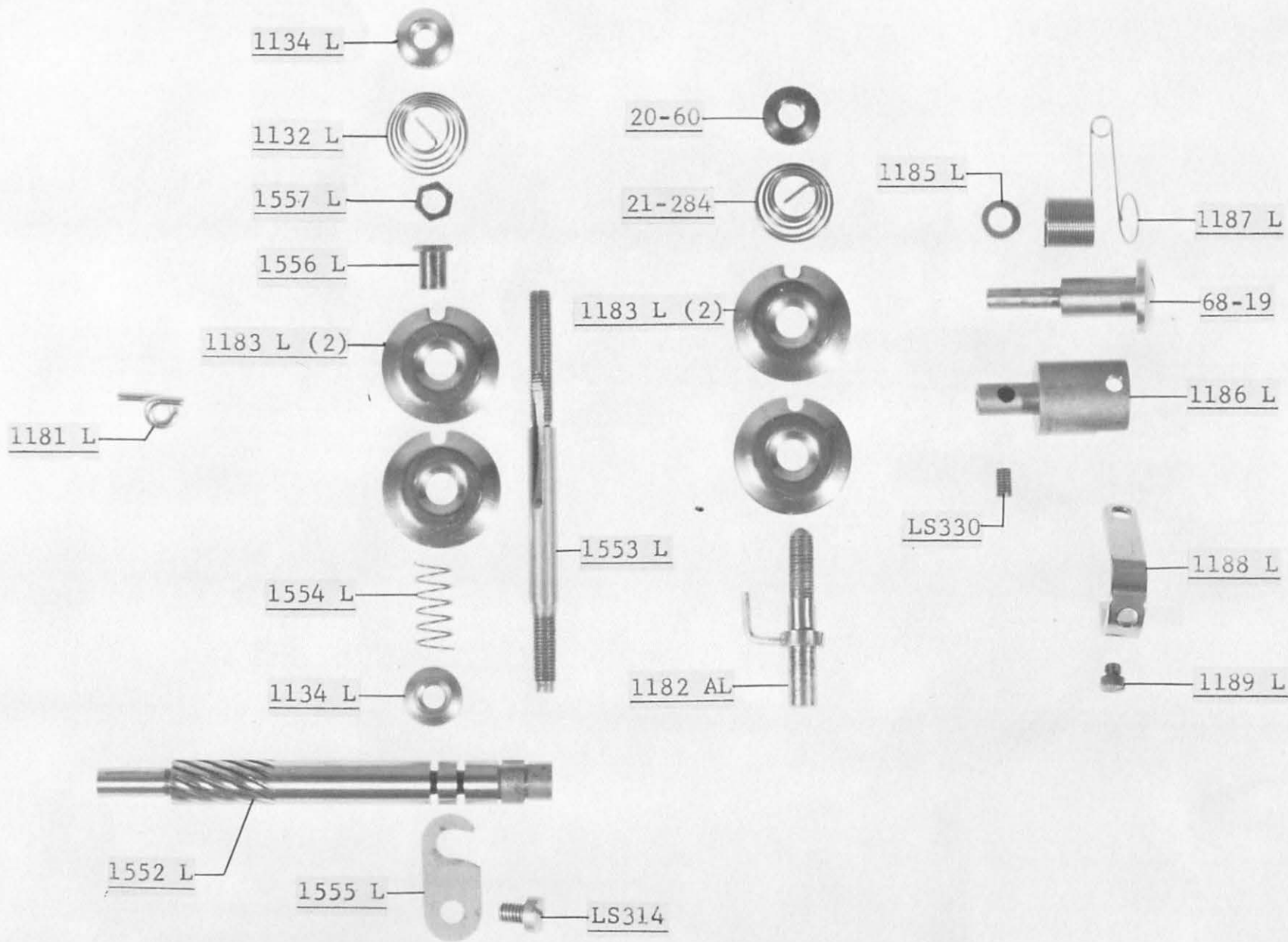



Union Special[®]
INDUSTRIAL SEWING MACHINES

UNION SPECIAL maintains sales and service facilities throughout the world. These offices will aid you in the selection of the right sewing equipment for your particular operation. Union Special representatives and service men are factory trained and are able to serve your needs promptly and efficiently. Whatever your location, there is a Union Special Representative to serve you. Check with him today.

ATLANTA, GA.

BOSTON, MASS.

CHICAGO, ILL.

DALLAS, TEXAS

LOS ANGELES, CAL.

NEW YORK, N. Y.

PHILADELPHIA, PA.

MONTREAL, CANADA

TORONTO, CANADA

BRUSSELS, BELGIUM

LEICESTER, ENGLAND

LONDON, ENGLAND

PARIS, FRANCE

STUTTGART, GERMANY

Representatives and distributors in all important
industrial cities throughout the world.

Union Special

MACHINE COMPANY

400 N. FRANKLIN ST., CHICAGO, ILL. 60610